

| TOLERANCE<br>UNLESS OTHERWISE<br>SPECIFIED |       |
|--|-------|
| .X   | ±0.25 |
| .XX  | ±0.13 |
| .XXX                                       | ±0.05 |

THIS IS A C.A.D. GENERATED DRAWING  
DO NOT MAKE MANUAL REVISIONS TO MASTER.



| ISSUE NUMBER |   |
|--------------|---|
| ORIGINAL     | ① |

CONTACT 100-290-251

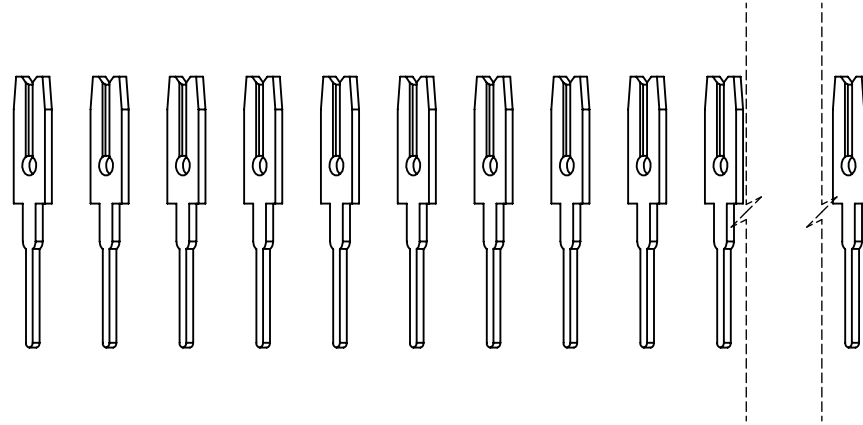
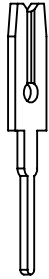

.200 CONTACT SPACING  
TOTAL NUMBER OF CONTACTS = 31

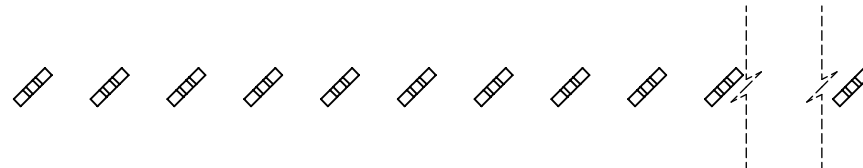

NOTE:  
CONTACTS ARE HELD IN  
A CARRIER FOR EASE OF ASSEMBLY

|   |  |                                  |                              |            |
|---|--|----------------------------------|------------------------------|------------|
| <b>106 SERIES - 45 DEGREE CONTACT PATTERN</b>   |  | ACAD REFERENCE NO.: 106 Assembly |                              |            |
|   |  | DRAWN: C.B                       | DATE: April 16, 2020         |            |
| <b>EDAC</b> INC<br>TORONTO, ONTARIO<br>CANADA<br>YOUR CONNECTION TO QUALITY & SERVICE   |  | CHECKED:                         | DATE:                        |            |
|   |  | SCALE: 2:1                       | SHEET 1 OF 1                 |            |
| THESE DRAWINGS AND SPECIFICATIONS ARE THE PROPERTY OF EDAC INC., AND SHALL NOT BE REPRODUCED, OR COPIED OR USED AS THE BASIS FOR THE MANUFACTURE OR SALE OF APPARATUS WITHOUT WRITTEN PERMISSION. |  |                                  | DRAWING NUMBER: 106 Assembly | ISSUE<br>1 |
|   |  |                                  | PART NUMBER: 106-031-251-200 |            |



THIS SERIES FULLY CONFORMS TO  
THE EUROPEAN UNION DIRECTIVES  
2011/65/EU FOR RoHS COMPLIANCY.