

| TOLERANCE<br>UNLESS OTHERWISE<br>SPECIFIED |      |
|--|------|
| .X   | ±0.3 |
| .XX  | ±0.2 |
| .XXX                                       | ±0.1 |

THIS IS A C.A.D. GENERATED DRAWING  
DO NOT MAKE MANUAL REVISIONS TO MASTER.

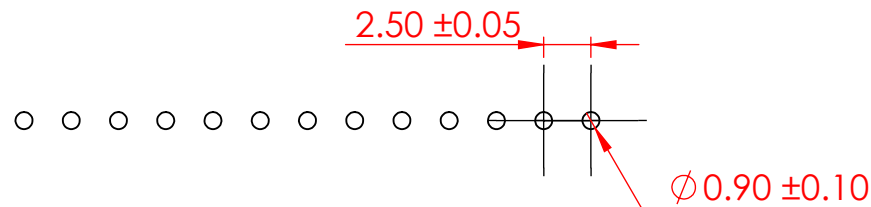

| ISSUE NUMBER |   |
|--------------|---|
| ORIGINAL     | ① |

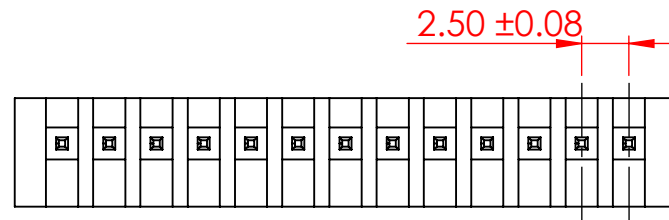
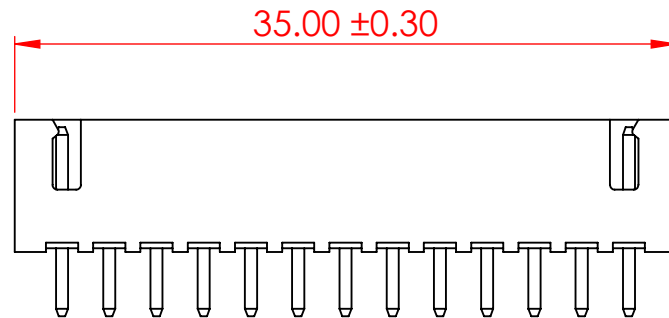

RECOMMENDED PCB LAYOUT

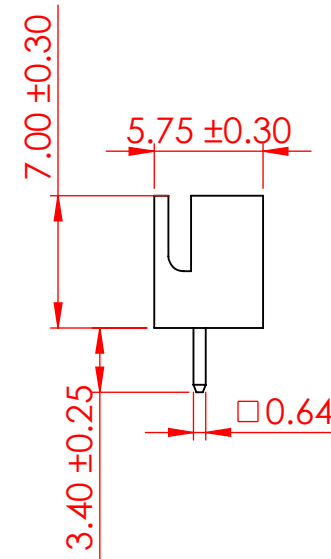

**SPECIFICATIONS:**  
**VOLTAGE RATING:** 250V AC/DC  
**CURRENT RATING:** 3A AC/DC  
**WITHSTANDING VOLTAGE:** 1000V AC/MIN  
**TEMPERATURE RANGE:** -40°C TO 105°C  
**INSULATION RESISTANCE:** ≥ 1000MΩ  
**CONTACT RESISTANCE:** ≤ 10mΩ

**INSULATOR MATERIAL:** NYLON 66, UL94V-0  
**COLOR-NATURAL**

**CONTACT:** BRASS, TIN PLATED

**MATES WITH HOUSING:** 14K-513-210-AA2



THIS SERIES FULLY CONFORMS TO  
THE EUROPEAN UNION DIRECTIVES  
2011/65/EU FOR RoHS COMPLIANCY.



YOUR CONNECTION TO QUALITY & SERVICE

EDAC INC  
TORONTO, ONTARIO  
CANADA

THESE DRAWINGS AND SPECIFICATIONS  
ARE THE PROPERTY OF EDAC INC., AND  
SHALL NOT BE REPRODUCED, OR COPIED  
OR USED AS THE BASIS FOR THE  
MANUFACTURE OR SALE OF APPARATUS  
WITHOUT WRITTEN PERMISSION.

### 14K SERIES PIN HEADER, 2.50 PITCH, TOP ENTRY THROUGH HOLE STRAIGHT

|                                  |                |          |
|----------------------------------|----------------|----------|
| ACAD REFERENCE NO.: 14K Assembly |                | UNIT: MM |
| DRAWN: V.K.                      | DATE: 02/14/24 |          |
| CHECKED: R.S.M.                  | DATE: 02/21/24 |          |
| SCALE: 2.5:1                     | SHEET 1 OF 1   |          |
| DRAWING NUMBER: 14K-513-415-AA1  | ISSUE 1        |          |
| PART NUMBER: 14K-513-415-AA1     |                |          |