

NOTES:
INSULATOR MATERIAL - POLYPHENYLENE SULPHIDE, UL 94V-0
CONTACT MATERIAL - PHOSPHOR BRONZE ALLOY
CONTACT PLATING - GOLD OVER NICKEL UNDERPLATE
MOUNTING OPTION - 02-.144 (3.66) Dia. Mounting Holes
CONTACT TYPE - 542-Wire Wrap .045 Sq.(1.14 Sq.) - Tail LG=.750(19.05)

TOLERANCE UNLESS OTHERWISE SPECIFIED	
.XX	±.01
.XXX	±.005
.XXXX	±.0005

THIS IS A C.A.D. GENERATED DRAWING
DO NOT MAKE MANUAL REVISIONS TO MASTER.



ISSUE NUMBER	
ORIGINAL	①

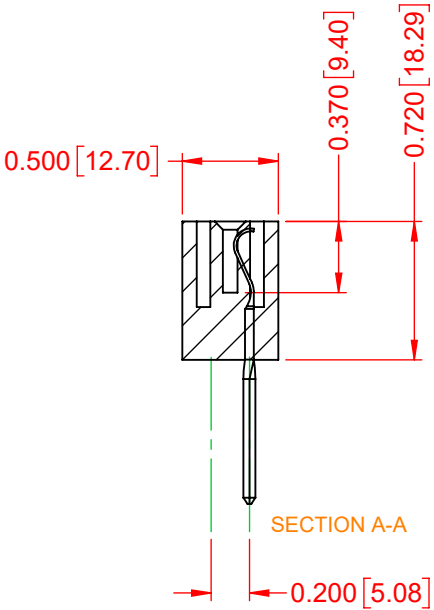
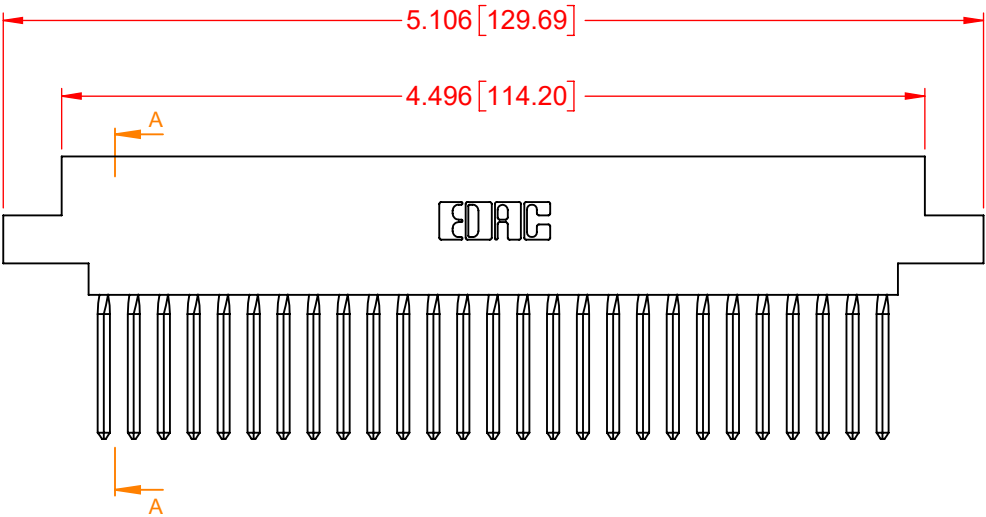
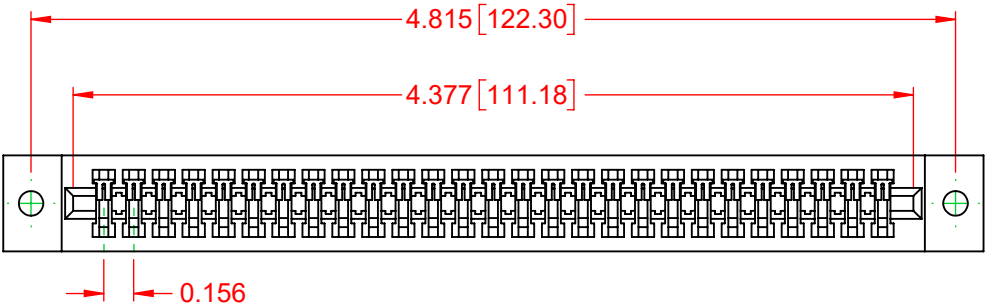

317 SERIES CARD EDGE CONNECTOR		ACAD REFERENCE NO.: 317 Assembly	
EDAC INC TORONTO, ONTARIO CANADA YOUR CONNECTION TO QUALITY & SERVICE		DRAWN: C.B	DATE: February 5, 2020
		CHECKED:	DATE:
THESE DRAWINGS AND SPECIFICATIONS ARE THE PROPERTY OF EDAC INC., AND SHALL NOT BE REPRODUCED, OR COPIED OR USED AS THE BASIS FOR THE MANUFACTURE OR SALE OF APPARATUS WITHOUT WRITTEN PERMISSION.		SCALE: 1:1	SHEET 1 OF 1
		DRAWING NUMBER: 317-027-542-602	ISSUE 1
		PART NUMBER: 317-027-542-602	



THIS SERIES FULLY CONFORMS TO
THE EUROPEAN UNION DIRECTIVES
2011/65/EU FOR RoHS COMPLIANCY.