

2 CONTACTS
ORANGE FEMALE HOUSING FOR WIRE INSULATION Ø1.00 TO Ø1.30

TOLERANCE UNLESS OTHERWISE SPECIFIED	
.X	±0.38
.XX	±0.25
.XXX	±0.13

THIS IS A C.A.D. GENERATED DRAWING
DO NOT MAKE MANUAL REVISIONS TO MASTER.



ISSUE NUMBER	
ORIGINAL	1

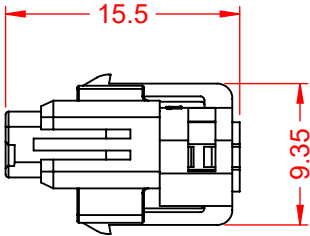
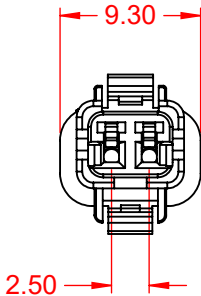

ISO 1:1

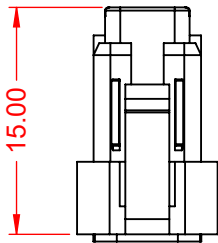
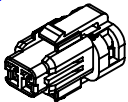

NOTE:
ELECTRICAL SPECIFICATIONS:
VOLTAGE RATING: 250V MAX.
CURRENT RATING: 3A per CONTACT
CONTACT RESISTANCE: 15mΩ MAX.
INSULATOR RESISTANCE: 1000MΩ min.
DIELECTRIC WITHSTANDING VOLTAGE: 1000V AC(RMS)
OPERATING TEMPERATURE: -40°C ~ 105°C

MATERIAL & FINISH:
HOUSING: PBT, UL94V-0
CONTACTS: PHOSPHOR BRONZE, TIN PLATED
SEALS: SILICONE RUBBER

560 SERIES WATERPROOF CONNECTOR

ACAD REFERENCE NO.: 560 Assembly	
DRAWN: C.B	DATE: July 23, 2020
CHECKED:	DATE:
SCALE: 2:1	SHEET 1 OF 1
DRAWING NUMBER: 560 Assembly	ISSUE 1
PART NUMBER: 560-002-000-610	



THIS SERIES FULLY CONFORMS TO
THE EUROPEAN UNION DIRECTIVES
2011/65/EU FOR RoHS COMPLIANCY.



YOUR CONNECTION TO QUALITY & SERVICE

EDAC INC
TORONTO, ONTARIO
CANADA

THESE DRAWINGS AND SPECIFICATIONS
ARE THE PROPERTY OF EDAC INC., AND
SHALL NOT BE REPRODUCED, OR COPIED
OR USED AS THE BASIS FOR THE
MANUFACTURE OR SALE OF APPARATUS
WITHOUT WRITTEN PERMISSION.