

5 CONTACTS  
ORANGE MALE HOUSING (ONLY FOR BOARD MOUNT CONTACTS)

TOLERANCE UNLESS OTHERWISE SPECIFIED	
.X	±0.38
.XX	±0.25
.XXX	±0.13

THIS IS A C.A.D. GENERATED DRAWING  
DO NOT MAKE MANUAL REVISIONS TO MASTER.



ISSUE NUMBER	
ORIGINAL	1

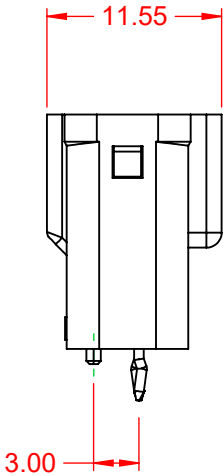
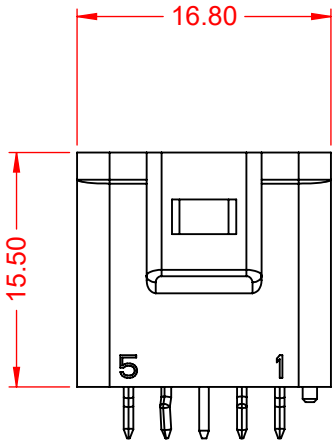

ISO 1:1

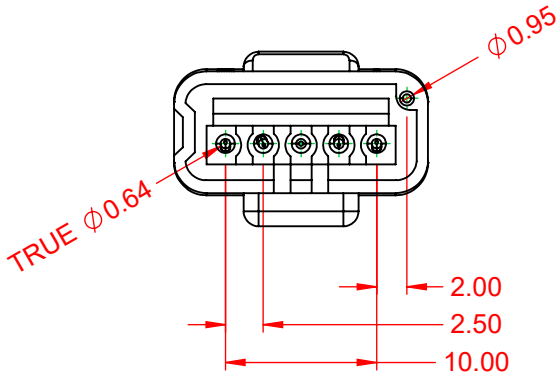
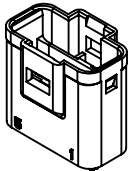

NOTE:  
ELECTRICAL SPECIFICATIONS:  
VOLTAGE RATING: 250V MAX.  
CURRENT RATING: 3A per CONTACT  
CONTACT RESISTANCE: 15mΩ MAX.  
INSULATOR RESISTANCE: 1000MΩ min.  
DIELECTRIC WITHSTANDING VOLTAGE: 1000V AC(RMS)  
OPERATING TEMPERATURE: -40°C ~ 105°C

MATERIAL & FINISH:  
HOUSING: PBT WITH GLASS, UL94V-0  
CONTACTS: BRASS, TIN PLATED  
SEALS: SILICONE RUBBER

560 SERIES WATERPROOF CONNECTOR

ACAD REFERENCE NO.: 560 Assembly	
DRAWN: C.B	DATE: July 23, 2020
CHECKED:	DATE:
SCALE: 2:1	SHEET 1 OF 1
DRAWING NUMBER: 560 Assembly	ISSUE 1
PART NUMBER: 560-005-420-501	



THIS SERIES FULLY CONFORMS TO  
THE EUROPEAN UNION DIRECTIVES  
2011/65/EU FOR RoHS COMPLIANCY.



EDAC INC  
TORONTO, ONTARIO  
CANADA  
YOUR CONNECTION TO QUALITY & SERVICE

THESE DRAWINGS AND SPECIFICATIONS  
ARE THE PROPERTY OF EDAC INC., AND  
SHALL NOT BE REPRODUCED, OR COPIED  
OR USED AS THE BASIS FOR THE  
MANUFACTURE OR SALE OF APPARATUS  
WITHOUT WRITTEN PERMISSION.