

TOLERANCE UNLESS OTHERWISE SPECIFIED	
.X	±0.25
.XX	±0.13
.XXX	±0.05

THIS IS A C.A.D. GENERATED DRAWING
DO NOT MAKE MANUAL REVISIONS TO MASTER.

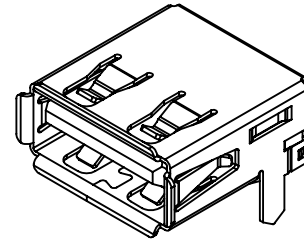

ISSUE NUMBER	
ORIGINAL	①

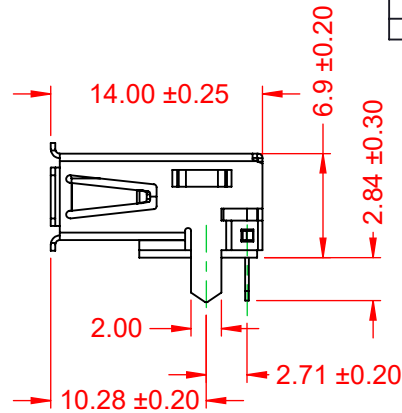
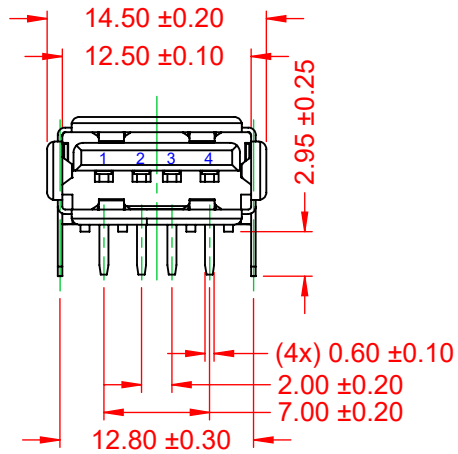

NOTES:

MATERIAL:
SHELL:
SHELL PLATING:
TERMINAL:
TERMINAL PLATING:

STAINLESS STEEL T=0.30mm
30µ" MIN NICKEL PLATED
PHOSPHOR BRONZE T=0.25mm
30µ" GOLD PLATED ON CONTACT AREA
80µ" MIN. TIN PLATED ON SOLDER TAILS,
50µ" MIN NICKEL UNDERPLATED OVERALL

HOUSING:

P.B.T. UL94V-0, WHITE

ELECTRICAL:
RATED VOLTAGE:
RATED CURRENT:
INSULATION RESISTANCE:
CONTACT RESISTANCE:
DIELECTRIC WITHSTANDING VOLTAGE:

30V rms MAX
1.5AMP
1000MΩ MIN. 500V DC, TEST TIME 1 SEC. MIN.
30mΩ MAX.
500V A, TEST TIME 1 SEC. MIN

ENVIRONMENTAL
OPERATING TEMPERATURE:
STORAGE TEMPERATURE:
STORAGE LIFE:
SALT SPRAY TEST:

-40°C TO +85°C
-20°C TO +60°C, RELATIVE HUMIDITY (%): 20% TO 70%
12 MONTHS MAX
48H

MECHANICAL:
INSERTION FORCE:
EXTRACTION FORCE:
DURABILITY:

35N MAX.
10N MIN.
5000 CYCLES

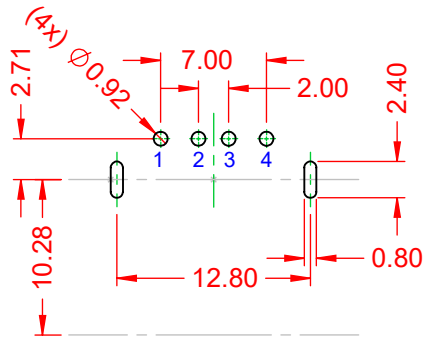

RECOMMENDED P.C.B HOLE LAYOUT
TOP VIEW (TOLERANCE: ±0.10)

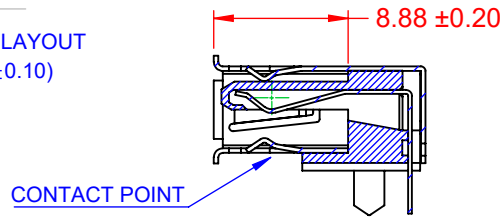
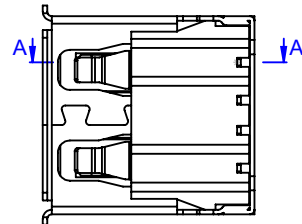

SECTION A-A



THIS SERIES FULLY CONFORMS TO
THE EUROPEAN UNION DIRECTIVES
2011/65/EU FOR RoHS COMPLIANCY.



YOUR CONNECTION TO QUALITY & SERVICE

EDAC INC
TORONTO, ONTARIO
CANADA

THESE DRAWINGS AND SPECIFICATIONS
ARE THE PROPERTY OF EDAC INC., AND
SHALL NOT BE REPRODUCED, OR COPIED
OR USED AS THE BASIS FOR THE
MANUFACTURE OR SALE OF APPARATUS
WITHOUT WRITTEN PERMISSION.

690 SERIES USB 2.0 TYPE-A RECEPTACLE
RIGHT ANGLE PCB

ACAD REFERENCE NO.: 690A104-621-020	
DRAWN: P.M.	DATE: DEC 17/2020
CHECKED: C.B	DATE: DEC 17/2020
SCALE: 2:1	SHEET 1 OF 1
DRAWING NUMBER: 690A104-621-020	ISSUE
PART NUMBER: 690A104-621-020	1