

TOLERANCE UNLESS OTHERWISE SPECIFIED	
.X	±0.25
.XX	±0.13
.XXX	±0.05

THIS IS A C.A.D. GENERATED DRAWING  
DO NOT MAKE MANUAL REVISIONS TO MASTER.

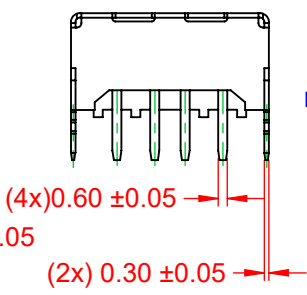

ISSUE NUMBER	
ORIGINAL	①



**NOTES:**

**MATERIAL**  
**SHELL:**  
**SHELL PLATING:**  
  
**TERMINAL:**  
**TERMINAL PLATING:**

STAINLESS STEEL T=0.30mm±0.02mm  
BRIGHT TIN 150µ" MINPLATED,  
NICKEL PLATED OVERALL  
COPPER ALLOY T=0.25 ±0.02mm  
30µ" GOLD PLATED ON CONTACT AREA  
150µ" MIN. TIN PLATED ON SOLDER TAILS,  
50µ" MIN NICKEL UNDERPLATED OVERALL

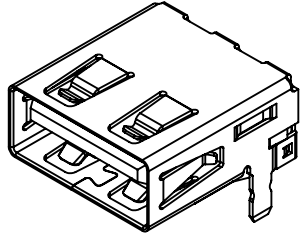
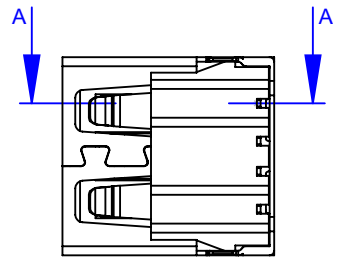

**HOUSING:**

THERMOPLASTIC, UL94V-0, BLACK

**ELECTRICAL:**

**RATED VOLTAGE:** 30V rms MAX  
**RATED CURRENT:** 3AMP  
**INSULATION RESISTANCE:** 1000MΩ MIN. 500V DC, TEST TIME 1 SEC. MIN.  
**CONTACT RESISTANCE:** 30mΩ MAX.  
**DIELECTRIC WITHSTANDING VOLTAGE:** 500V AC, TEST TIME 1 SEC. MIN

**ENVIRONMENTAL**

**OPERATING TEMPERATURE:** -40°C TO +85°C  
**STORAGE TEMPERATURE:** -40°C TO +85°C, RELATIVE HUMIDITY (%): 20% TO 70%

**STORAGE LIFE:**  
**SALT SPRAY TEST:**

6 MONTHS MAX  
48H MAX

**MECHANICAL:**

**INSERTION FORCE:** 35N MAX.  
**EXTRACTION FORCE:** 8 TO 35N.(AFTER THE TEST:8N MIN)  
**DURABILITY:** 10000 CYCLES  
**THE PEAK OF TEMPERATURE ON SOLDERING:** PIP:260±5°C 5 TO 10S

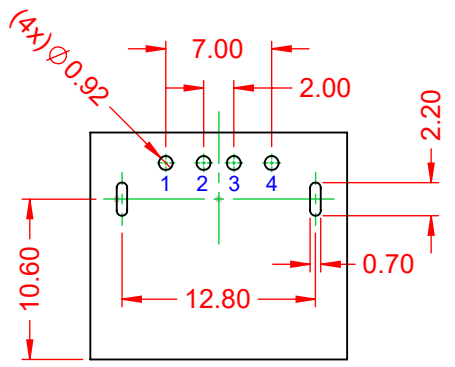
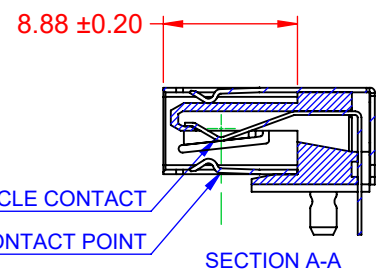

RECOMMENDED PCB LAYOUT (TOP VIEW)  
P.C.B. THICKNESS = 1.60 (TOLERANCE = ±0.05)



THIS SERIES FULLY CONFORMS TO THE EUROPEAN UNION DIRECTIVES 2011/65/EU FOR RoHS COMPLIANCY.

**EDAC** EDAC INC  
TORONTO, ONTARIO  
CANADA  
YOUR CONNECTION TO QUALITY & SERVICE

THESE DRAWINGS AND SPECIFICATIONS ARE THE PROPERTY OF EDAC INC., AND SHALL NOT BE REPRODUCED, OR COPIED OR USED AS THE BASIS FOR THE MANUFACTURE OR SALE OF APPARATUS WITHOUT WRITTEN PERMISSION.

690 SERIES USB 2.0 TYPE-A RECEPTACLE RIGHT ANGLE PCB		ACAD REFERENCE NO.: 690A104-621-241	
		DRAWN: P.M.	DATE: DEC 17/2020
CHECKED: C.B	DATE: DEC 17/2020		
SCALE: 2:1	SHEET 1 OF 1		
DRAWING NUMBER: 690A104-621-241	ISSUE		
PART NUMBER: 690A104-621-241	1		