

TOLERANCE UNLESS OTHERWISE SPECIFIED	
.X	±0.25
.XX	±0.15
.XXX	±0.05

THIS IS A C.A.D. GENERATED DRAWING
DO NOT MAKE MANUAL REVISIONS TO MASTER.

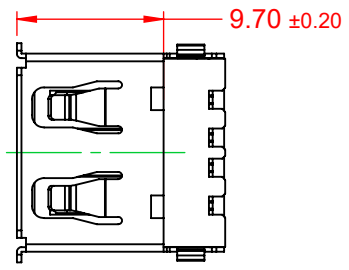

ISSUE NUMBER	
ORIGINAL	①

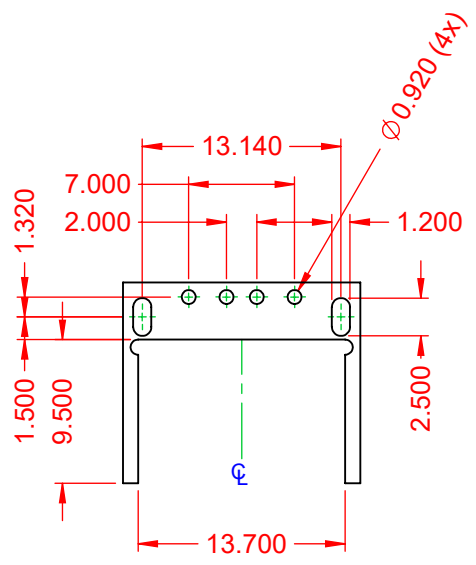
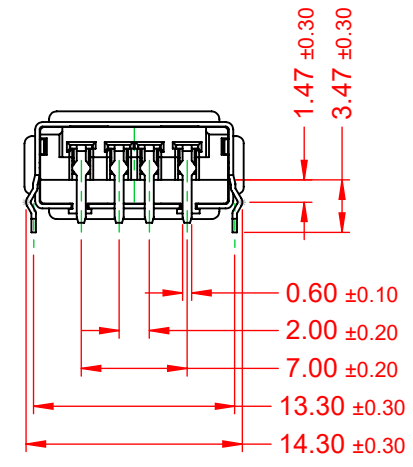
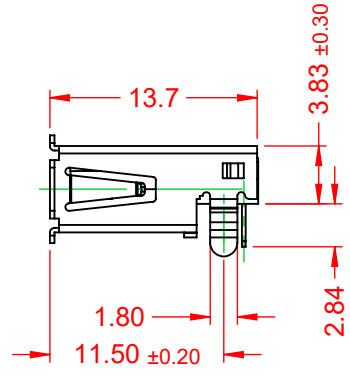
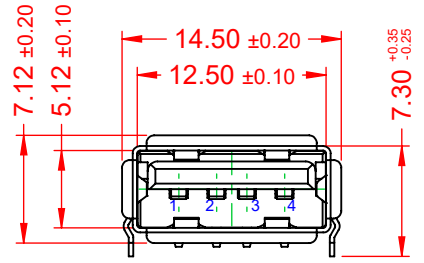
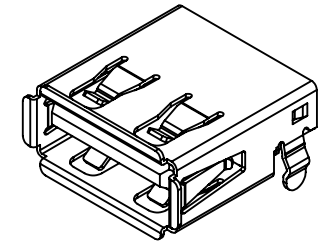
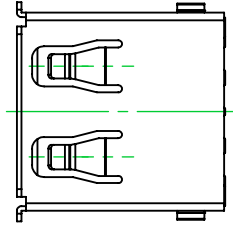

NOTE:
ELECTRICAL SPECIFICATIONS:
 VOLTAGE RATING: 30V MAX.
 CURRENT RATING: 1.5A
 CONTACT RESISTANCE: 30mΩ MAX.
 INSULATOR RESISTANCE: 1000MΩ min.
 DIELECTRIC WITHSTANDING VOLTAGE: 500V AC
 OPERATING TEMPERATURE: -40°C ~ 85°C

MATERIAL & FINISH:
 SHELL: COPPER ALLOY, T=0.30, NICKEL PLATED
 HOUSING: PBT, BLACK IN COLOUR, UL94V-0
 CONTACTS: COPPER ALLOY, T=0.25, 3µ" GOLD PLATED

RECOMMENDED P.C.B HOLE LAYOUT
CONNECTOR SIDE / TOP VIEW

690 SERIES RECEPTACLES USB TYPE-A MID-MOUNT PCB		ACAD REFERENCE NO.: 690G104-X53-02X	
DRAWN: C.B		DATE: December 16, 2020	
CHECKED:		DATE:	
SCALE: 2:1		SHEET 1 OF 1	
DRAWING NUMBER: 690G104-X53-02X			ISSUE
PART NUMBER: 690G104-153-021			1



THIS SERIES FULLY CONFORMS TO
THE EUROPEAN UNION DIRECTIVES
2011/65/EU FOR RoHS COMPLIANCY.

EDAC
 EDAC INC
 TORONTO, ONTARIO
 CANADA
 YOUR CONNECTION TO QUALITY & SERVICE

THESE DRAWINGS AND SPECIFICATIONS
ARE THE PROPERTY OF EDAC INC., AND
SHALL NOT BE REPRODUCED, OR COPIED
OR USED AS THE BASIS FOR THE
MANUFACTURE OR SALE OF APPARATUS
WITHOUT WRITTEN PERMISSION.