

TOLERANCE UNLESS OTHERWISE SPECIFIED	
.X	±0.25
.XX	±0.13
.XXX	±0.05

THIS IS A C.A.D. GENERATED DRAWING  
DO NOT MAKE MANUAL REVISIONS TO MASTER.

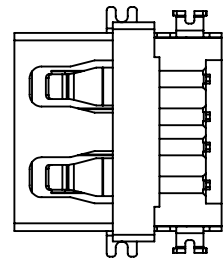

ISSUE NUMBER	
ORIGINAL	①

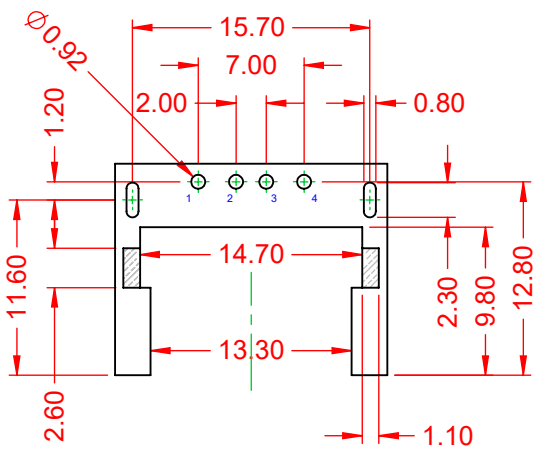
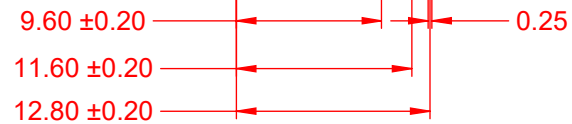
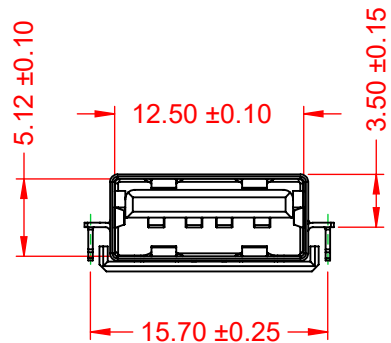
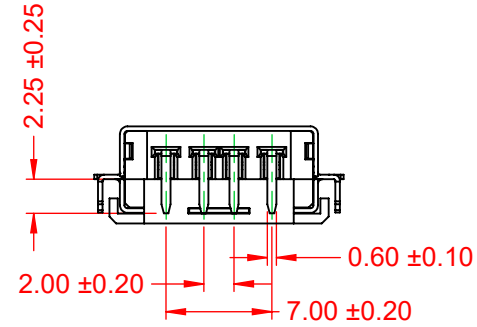
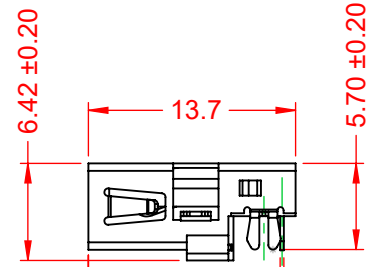
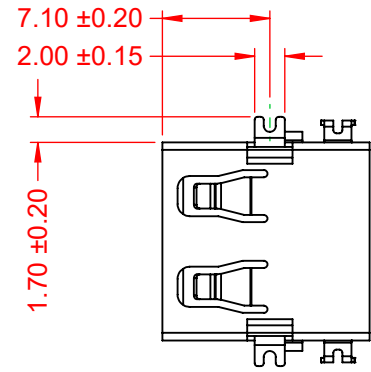
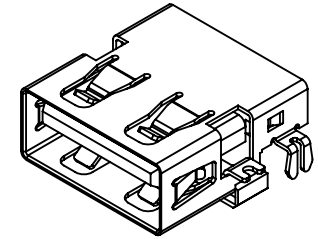

**NOTE:**  
**ELECTRICAL SPECIFICATIONS:**  
 VOLTAGE RATING: 30V MAX.  
 CURRENT RATING: 1.5A per CONTACT  
 CONTACT RESISTANCE: 30mΩ MAX.  
 INSULATOR RESISTANCE: 1000MΩ min.  
 DIELECTRIC WITHSTANDING VOLTAGE: 500V AC  
 OPERATING TEMPERATURE: -20°C ~ 60°C

**MATERIAL & FINISH:**  
 SHELL: T=0.30, NICKEL/TIN PLATED COPPER ALLOY  
 HOUSING: PA6T, BLACK IN COLOUR, UL94V-0  
 CONTACTS: 6μ" GOLD PLATED COPPER ALLOY

RECOMMENDED P.C.B LAYOUT  
TOP VIEW (TOLERANCE:±0.05mm)



THIS SERIES FULLY CONFORMS TO  
THE EUROPEAN UNION DIRECTIVES  
2011/65/EU FOR RoHS COMPLIANCY.

**EDAC** EDAC INC  
TORONTO, ONTARIO  
CANADA  
YOUR CONNECTION TO QUALITY & SERVICE

THESE DRAWINGS AND SPECIFICATIONS  
ARE THE PROPERTY OF EDAC INC., AND  
SHALL NOT BE REPRODUCED, OR COPIED  
OR USED AS THE BASIS FOR THE  
MANUFACTURE OR SALE OF APPARATUS  
WITHOUT WRITTEN PERMISSION.

690 SERIES RECEPTACLES USB TYPE-A MID-MOUNT PCB		ACAD REFERENCE NO.: 690G104-X59-24X	
DRAWN: C.B	CHECKED:	DATE: December 16, 2020	DATE:
SCALE: 2:1	SHEET 1 OF 1		ISSUE
DRAWING NUMBER: 690G104-X59-24X	PART NUMBER: 690G104-359-241		1