

TOLERANCE UNLESS OTHERWISE SPECIFIED	
.X	±0.25
.XX	±0.13
.XXX	±0.05

THIS IS A C.A.D. GENERATED DRAWING
DO NOT MAKE MANUAL REVISIONS TO MASTER.

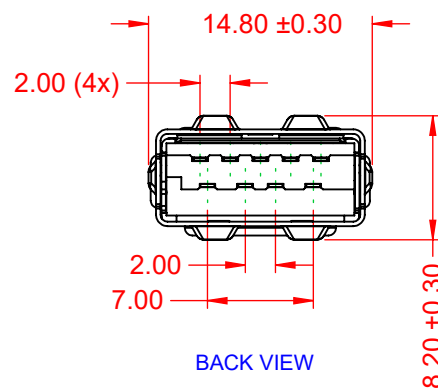
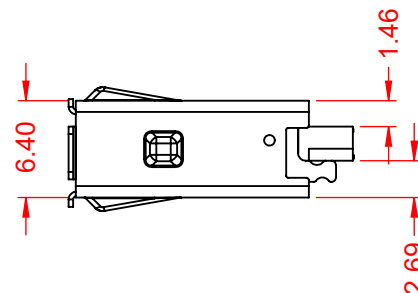
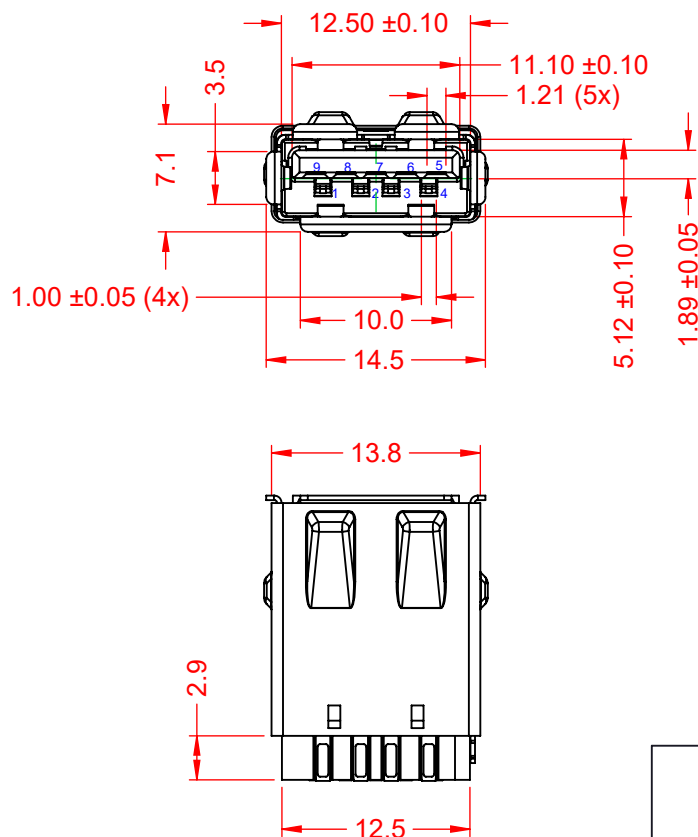
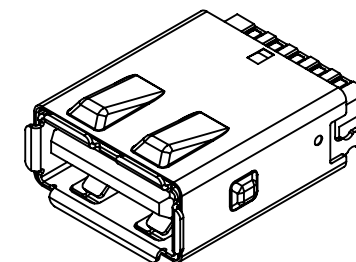
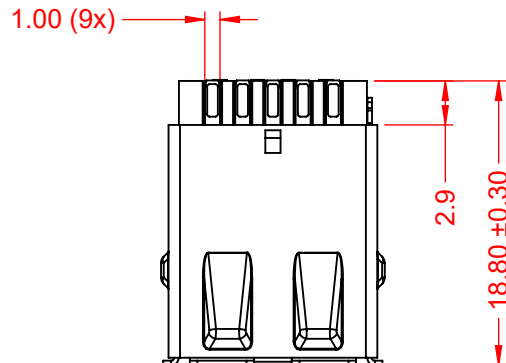

NOTE:
ELECTRICAL SPECIFICATIONS:
 VOLTAGE RATING: 30V MAX.
 CURRENT RATING: 1.8A
 CONTACT RESISTANCE: 30mΩ MAX.
 INSULATOR RESISTANCE: 100MΩ min.
 DIELECTRIC WITHSTANDING VOLTAGE: 100V AC
 OPERATING TEMPERATURE: -25°C ~ 85°C

MATERIAL & FINISH:
 JACKET: STAINLESS STEEL, T=0.30, NICKEL PLATING
 SHELL: COPPER ALLOY, T=0.30, NICKEL PLATING
 HOUSING: PBT, WHITE IN COLOUR, UL94V-0
 CONTACTS: COPPER ALLOY, T=0.20, 30µ" GOLD PLATING

<p>690 SERIES RECEPTACLES USB 3.0 TYPE-A CABLE END SOLDER CUP</p>		ACAD REFERENCE NO.: 690M109JXAD-02X	
		DRAWN: C.B	DATE: December 18, 2020
EDAC INC TORONTO, ONTARIO CANADA YOUR CONNECTION TO QUALITY & SERVICE		CHECKED:	DATE:
THESE DRAWINGS AND SPECIFICATIONS ARE THE PROPERTY OF EDAC INC., AND SHALL NOT BE REPRODUCED, OR COPIED OR USED AS THE BASIS FOR THE MANUFACTURE OR SALE OF APPARATUS WITHOUT WRITTEN PERMISSION.		SCALE: 2:1	SHEET 1 OF 1
DRAWING NUMBER: 690M109JXAD-02X			ISSUE
PART NUMBER: 690M109J6AD-020			1



THIS SERIES FULLY CONFORMS TO THE EUROPEAN UNION DIRECTIVES 2011/65/EU FOR RoHS COMPLIANCY.