

THIS IS A C.A.D. GENERATED DRAWING  
DO NOT MAKE MANUAL REVISIONS TO MASTER.

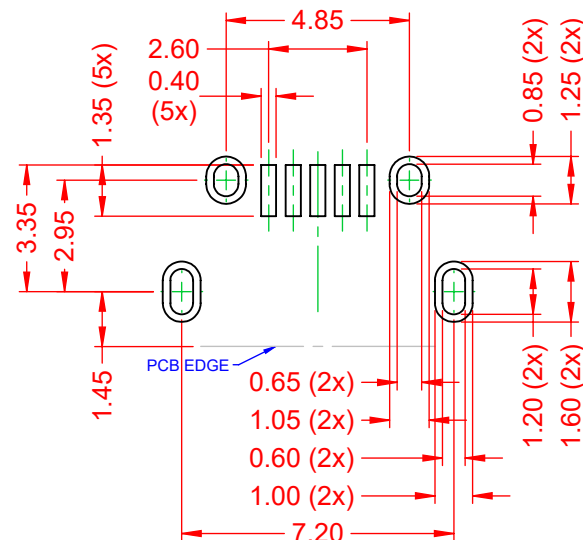

| TOLERANCE<br>UNLESS OTHERWISE<br>SPECIFIED |       |
|--|-------|
| .X   | ±0.25 |
| .XX  | ±0.20 |
| .XXX                                       | ±0.10 |
| .XXXX                                      | ±0.05 |

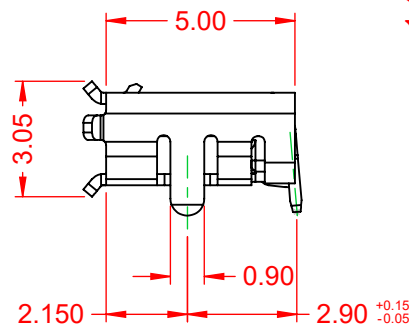
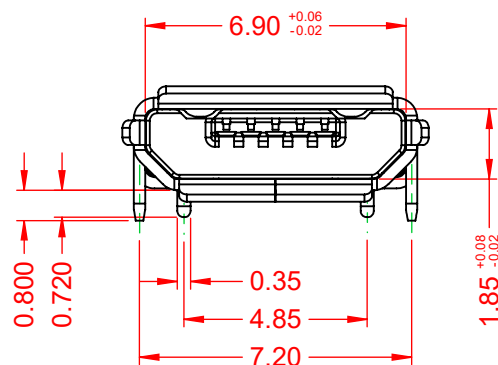
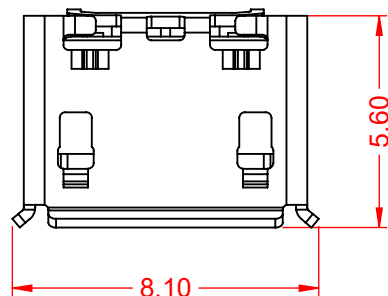

RECOMMENDED P.C.B HOLE LAYOUT  
TOP VIEW - TOL' = ±0.05

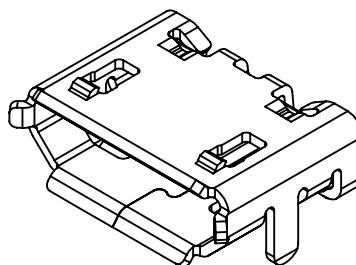
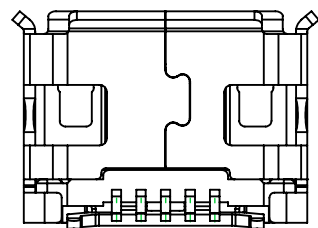

**NOTE:**

**ELECTRICAL SPECIFICATIONS:**

- VOLTAGE RATING: 30V MAX.
- CURRENT RATING: 1.8A
- CONTACT RESISTANCE: 30mΩ MAX.
- INSULATOR RESISTANCE: 1000MΩ min.
- DIELECTRIC WITHSTANDING VOLTAGE: 100V AC
- OPERATING TEMPERATURE: -20°C ~ 85°C

**MATERIAL & FINISH:**

- SHELL: STAINLESS STEEL, NICKEL PLATED
- HOUSING: LCP, BLACK IN COLOUR, UL94V-0
- CONTACTS: COPPER ALLOY, 6μ" GOLD PLATED



THIS SERIES FULLY CONFORMS TO  
THE EUROPEAN UNION DIRECTIVES  
2011/65/EU FOR RoHS COMPLIANCY.

**690 SERIES MICRO-USB RECEPTACLE**



EDAC INC  
TORONTO, ONTARIO  
CANADA

YOUR CONNECTION TO QUALITY & SERVICE

THESE DRAWINGS AND SPECIFICATIONS  
ARE THE PROPERTY OF EDAC INC., AND  
SHALL NOT BE REPRODUCED, OR COPIED  
OR USED AS THE BASIS FOR THE  
MANUFACTURE OR SALE OF APPARATUS  
WITHOUT WRITTEN PERMISSION.

|                                     |                         |
|-------------------------------------|-------------------------|
| ACAD REFERENCE NO.: 690T505-X62-01X |                         |
| DRAWN: C.B                          | DATE: December 23, 2020 |
| CHECKED:                            | DATE:                   |
| SCALE: 5:1                          | SHEET 1 OF 1            |
| DRAWING NUMBER: 690T505-X62-01X     | ISSUE                   |
| PART NUMBER: 690T505-362-011        | 1                       |