

TOLERANCE UNLESS OTHERWISE SPECIFIED	
.X	±0.25
.XX	±0.15
.XXX	±0.05

THIS IS A C.A.D. GENERATED DRAWING
DO NOT MAKE MANUAL REVISIONS TO MASTER.



ISSUE NUMBER

ORIGINAL

1

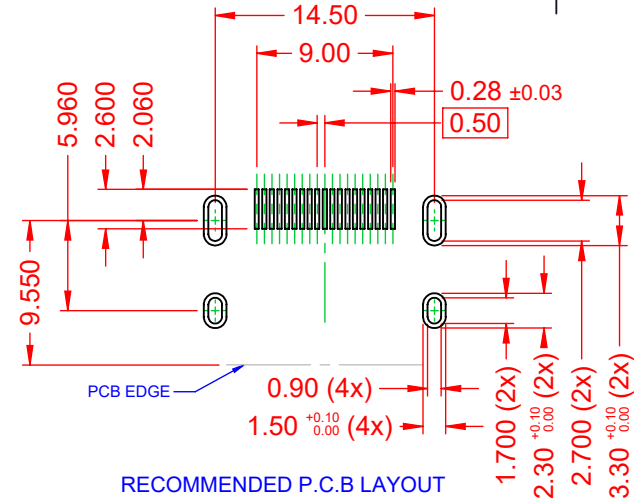
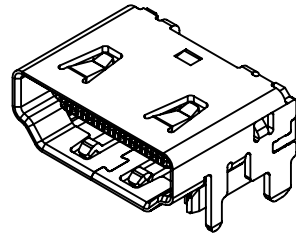
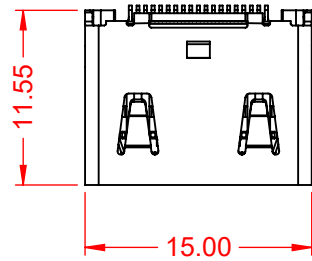

NOTE:
ELECTRICAL SPECIFICATIONS:
 CURRENT RATING: 0.5A
 VOLTAGE RATING: 40V AC
 CONTACT RESISTANCE: 10mΩ MAX.
 DIELECTRIC WITHSTANDING VOLTAGE: 500V AC/ 1 MINUTE
 INSULATOR RESISTANCE:
 A) UNMATED: 100MΩ min. @ 500 VDC
 B) MATED: 10M min. @ 150 VDC
 OPERATING TEMPERATURE: -20°C~85°C
 STORAGE TEMPERATURE: -20°C~65°C

MATERIAL & FINISH:
 SHELL: COPPER ALLOY, NICKEL PLATED
 HOUSING: LCP, BLACK IN COLOUR, UL94V-0
 CONTACTS: COPPER ALLOY, GOLD FLASH PLATED

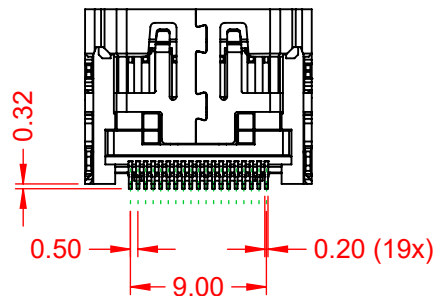
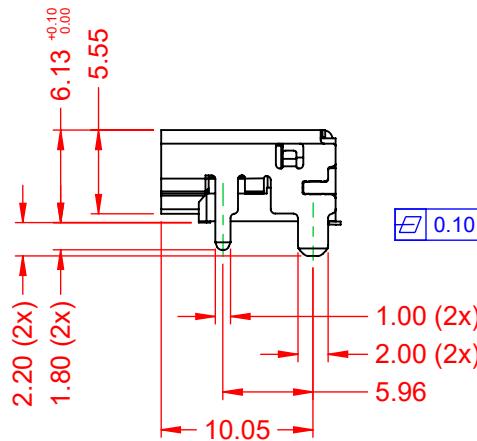
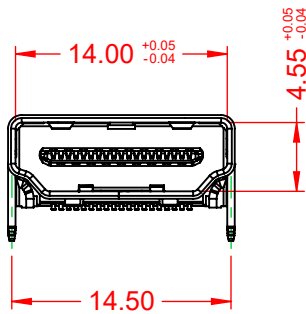

HDMI TYPE A RECEPTACLE - RIGHT ANGLE SMT		ACAD REFERENCE NO.: 694D119-X68-011	
		DRAWN: C.B	DATE: January 8, 2021
 EDAC INC TORONTO, ONTARIO CANADA YOUR CONNECTION TO QUALITY & SERVICE		CHECKED:	
		DATE:	
THESE DRAWINGS AND SPECIFICATIONS ARE THE PROPERTY OF EDAC INC., AND SHALL NOT BE REPRODUCED, OR COPIED OR USED AS THE BASIS FOR THE MANUFACTURE OR SALE OF APPARATUS WITHOUT WRITTEN PERMISSION.		SCALE: 2:1	SHEET 1 OF 1
		DRAWING NUMBER: 694D119-X68-011	
		PART NUMBER: 694D119-268-011	1

