

TOLERANCE UNLESS OTHERWISE SPECIFIED	
.X	±0.25
.XX	±0.13
.XXX	±0.05

THIS IS A C.A.D. GENERATED DRAWING  
DO NOT MAKE MANUAL REVISIONS TO MASTER.

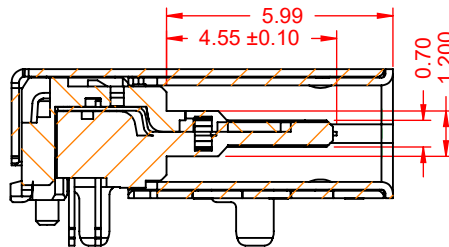

ISSUE NUMBER  
ORIGINAL ①



SECTION A-A

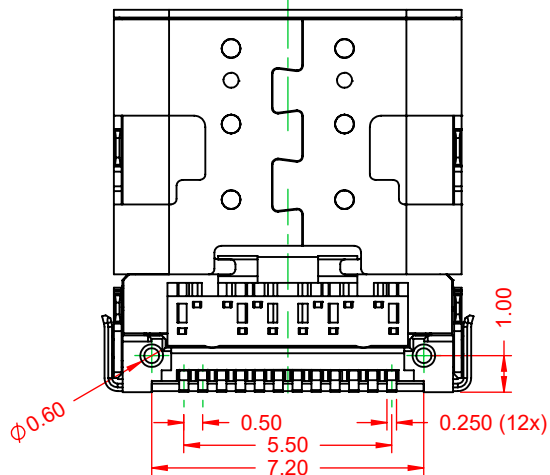
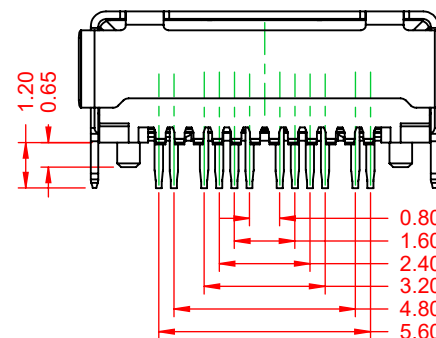
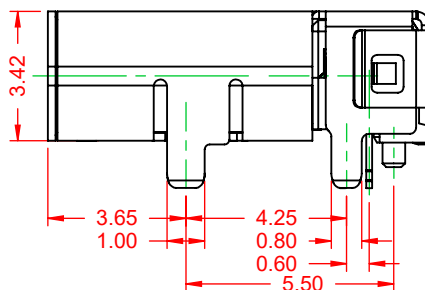
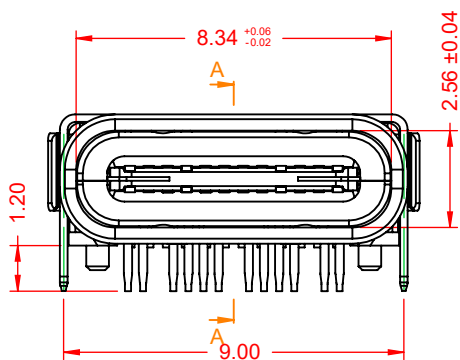
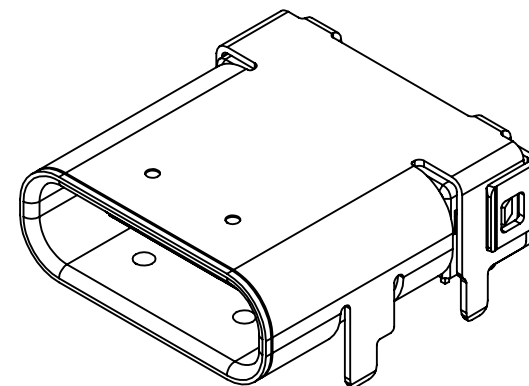

**NOTE:**

**ELECTRICAL SPECIFICATIONS:**

- CURRENT RATING: 5A
- CONTACT RESISTANCE: 40mΩ MAX.
- INSULATOR RESISTANCE: 100MΩ min.
- DIELECTRIC WITHSTANDING VOLTAGE: 100V AC
- OPERATING TEMPERATURE: -40°C ~ 85°C

**MATERIAL & FINISH:**

- SHELL: STAINLESS STEEL, NICKEL PLATING
- HOUSING: LCP, BLACK IN COLOUR, UL94V-0
- CONTACTS: COPPER ALLOY, 15µ" GOLD PLATING

**690 SERIES RECEPTACLES USB  
TYPE-C 24 PIN OPTION**

ACAD REFERENCE NO.: 698C124-504-211	
DRAWN: C.B	DATE: December 22, 2020
CHECKED:	DATE:
SCALE: 5:1	SHEET 1 OF 2
DRAWING NUMBER: 698C124-504-211	ISSUE
PART NUMBER: 698C124-504-211	1



THIS SERIES FULLY CONFORMS TO  
THE EUROPEAN UNION DIRECTIVES  
2011/65/EU FOR RoHS COMPLIANCY.



EDAC INC  
TORONTO, ONTARIO  
CANADA  
YOUR CONNECTION TO QUALITY & SERVICE

THESE DRAWINGS AND SPECIFICATIONS  
ARE THE PROPERTY OF EDAC INC., AND  
SHALL NOT BE REPRODUCED, OR COPIED  
OR USED AS THE BASIS FOR THE  
MANUFACTURE OR SALE OF APPARATUS  
WITHOUT WRITTEN PERMISSION.

