

TOLERANCE UNLESS OTHERWISE SPECIFIED	
.X	±---
.XX	±---
.XXX	±.005

THIS IS A C.A.D. GENERATED DRAWING
DO NOT MAKE MANUAL REVISIONS TO MASTER.

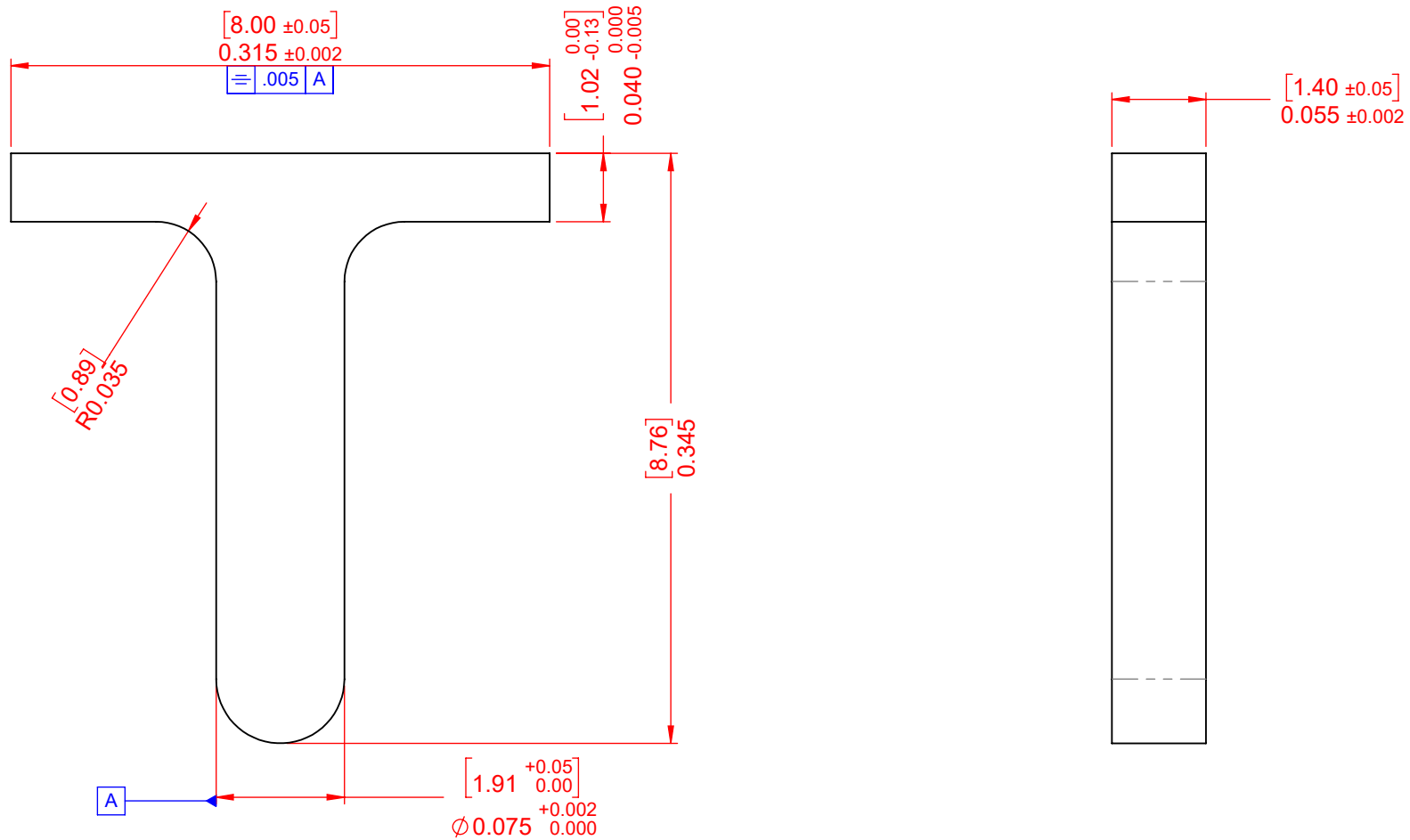

ISSUE NUMBER	
ORIGINAL	①
CONVERTED TO SW2020 C.B AUG. 21/2020	⑨



NOTE: FOR ORIGINAL DRAWING SEE BE-346-240-001
MATERIAL & FINISH: NYLON 66, NATURAL IN COLOR



THIS SERIES FULLY CONFORMS TO
THE EUROPEAN UNION DIRECTIVES
2011/65/EU FOR RoHS COMPLIANCY.



EDAC INC
TORONTO, ONTARIO
CANADA
YOUR CONNECTION TO QUALITY & SERVICE

THESE DRAWINGS AND SPECIFICATIONS
ARE THE PROPERTY OF EDAC INC., AND
SHALL NOT BE REPRODUCED, OR COPIED
OR USED AS THE BASIS FOR THE
MANUFACTURE OR SALE OF APPARATUS
WITHOUT WRITTEN PERMISSION.

ACAD REFERENCE NO.: 346-240-318	
DRAWN: P.L	DATE: JUL, 26/1983
CHECKED: R. WEAVER	DATE: JUL, 26/1983
SCALE: 10:1	SHEET 1 OF 1
DRAWING NUMBER: 346-240-318	ISSUE 9
PART NUMBER: 346-240-318	